

## MESSING PLATSTAF - L=3000

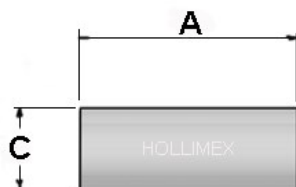

Artikelcode	A	C	E	Kwaliteit	Gewicht
4800-3971	10	2	L=3000	CuZn39Pb3	0.16
4800-40702	12	8	L=3000	CuZn39Pb3	0.83
4800-5277	15	2	L=3000	CuZn39Pb3	0.33
4800-40693	15	3	L=3000	CuZn39Pb3	0.39
4800-40694	20	3	L=3000	CuZn39Pb3	0.52
4800-2243	20	4	L=3000	CuZn39Pb3	0.70
4800-40703	20	8	L=3000	CuZn39Pb3	1.38
4800-40706	20	10	L=3000	CuZn39Pb3	1.72
4800-40711	20	15	L=3000	CuZn39Pb3	2.58
4800-40695	25	4	L=3000	CuZn39Pb3	0.86
4800-40704	25	8	L=3000	CuZn39Pb3	1.72
4800-40696	30	5	L=3000	CuZn39Pb3	1.29
4800-40700	30	6	L=3000	CuZn39Pb3	1.55
4800-40707	30	10	L=3000	CuZn39Pb3	2.58
4800-40712	30	15	L=3000	CuZn39Pb3	3.87
4800-40715	30	20	L=3000	CuZn39Pb3	5.16
4800-40697	35	5	L=3000	CuZn39Pb3	1.50
4800-40705	35	8	L=3000	CuZn39Pb3	2.41
4800-40698	40	5	L=3000	CuZn39Pb3	1.72
4800-40701	40	6	L=3000	CuZn39Pb3	2.06
4800-40708	40	10	L=3000	CuZn39Pb3	3.44
4800-40713	40	15	L=3000	CuZn39Pb3	5.16
4800-40716	40	20	L=3000	CuZn39Pb3	6.88
4800-40719	40	25	L=3000	CuZn39Pb3	8.60
4800-40709	50	10	L=3000	CuZn39Pb3	4.30
4800-40710	50	12	L=3000	CuZn39Pb3	5.16
4800-40714	50	15	L=3000	CuZn39Pb3	6.45

# HOLLIMEX

STAINLESS STEEL & OTHER METALS

4800-40717	50	20	L=3000	CuZn39Pb3	8.60
4800-40720	50	25	L=3000	CuZn39Pb3	10.75
4800-40699	60	5	L=3000	CuZn39Pb3	2.58
4800-12615	80	10	L=3000	CuZn39Pb3	6.80
4800-40718	80	20	L=3000	CuZn39Pb3	13.76

Kilweg 2 • 3336 LL Zwijndrecht • The Netherlands • **T:** (+)31 (0)85-0212750 • **F:** (+)31 (0)85-0212765

**E:** sales@hollimex.nl • **I:** www.hollimex.nl • **K.v.K.:** 29042925 • **BTW / VAT:** NL804201754B01

**ING Bank:** 694610194 • **IBAN:** NL02 INGB 0694 6101 94 • **BIC:** INGBNL2A

Buizen • Profielen • Staf • Platen • Appendages • Flenzen • Fittingen • Koppelingen • Vlinderkleppen • Kranen • Afsluiters • Montagemiddelen • Bewerkingen • Maatwerk